

1 LANDSCAPE PLAN
SCALE: 1"=20'

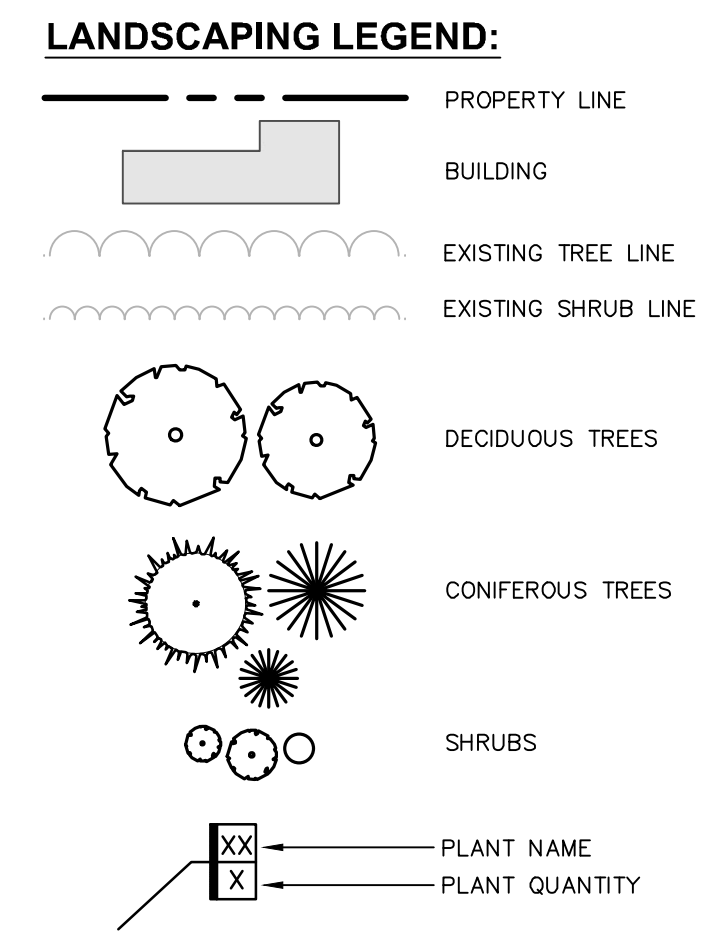

LANDSCAPING NOTES:
1. SEE SHEET C580 FOR LANDSCAPING NOTES.

PLANT LIST

QTY	ABRV	BOTANICAL NAME	COMMON NAME	SIZE	COND	SPACING	REMARKS
TREES							
1	AG	Amelanchier grandiflora 'Autumn Brilliance'	Apple Serviceberry	7'-8'	B&B	As Shown	Multi-Stem Clump
2	AM	Amelanchier canadensis	Serviceberry	25' - 30' Ht.	Cont.	As Shown	
1	CF	Cornus florida	Flowering Dogwood	6' - 7' Ht.	B&B	As Shown	
2	GT	Gleditsia triacanthos inermis	Thornless Honeylocust	3" Cal.	B&B	As Shown	
3	PG	Picea glauca	White Spruce	8' - 10'	B&B	As Shown	
6	PP	Picea pungens	Blue Spruce	8-10'	B&B	As Shown	
4	QR	Quercus rubra	Red Oak	2 - 2.5" Cal.	B&B	As Shown	
3	TC	Tilia cordata 'littleleaf'	Littleleaf Linden	2 - 2.5" Cal.	B&B	As Shown	Greenspire, Glenleven
3	JV	Juniperus virginiana	Eastern Red Cedar	8'-10'	B&B	As Shown	
SHRUBS							
9	Bc	Buxus microphylla 'Compacta'	Boxwood 'Compacta'	3 Gal	Cont.	As Shown	
5	Bg	Buxus microphylla 'Green Mountain'	Boxwood 'Green Mountain'	30"-36" Ht	B&B	As Shown	
4	Ca	Ceanothus americanus	New Jersey Tea	2'-3' Ht	As Shown	As Shown	
16	Cp	Comptonia peregrina	Sweetfern	#2	Cont.	As Shown	
7	Cr	Cornus racemosa	Gray Dogwood	18"-24"	Cont.	As Shown	
34	Jh	Juniperus horizontalis 'Wiltonii'	Creeping Juniper	#3 Cont.	Cont.	As Shown	
4	Js	Juniperus scopulorum 'Bailligh'	'Sky High' Juniper	5'-6' ht.	B&B	As Shown	
10	Mp	Myrica pensylvanica	Northern Bayberry	30-36"	Cont.	As Shown	
4	Tv	Itea virginica	Sweetspire	#5 Cont.	Cont.	As Shown	'Little Henry' Cultivar option
15	Xg	Ilex glabra 'Densa'	Compact Inkberry	#5 Cont.	Cont.	As Shown	
PERENNIALS							
26	or	Osmunda regalis	Royal Fern		#2 Cont.	18" O.C.	
5	pd	Phlox divaricata	Woodland Phlox		#2 Cont.	10" O.C.	
18	pv	Panicum virgatum 'Shenandoah'	Switch Grass		#2	Cont.	As Shown

* ALL DISTURBED AREAS NOT SPECIFICALLY CALLED OUT FOR NEW IMPROVEMENTS SHALL BE TOPSOILED, SEEDED WITH LAWN SEED MIX, & MULCHED (TYP)

ISSUED FOR PLANNING BOARD REVIEW - NOT FOR CONSTRUCTION

Dig Safely. New York
 Call Before You Dig
 Wait The Required Time
 Confirm Utility Response
 Respect The Marks
 Dig With Care
800-962-7962
 www.digsafelynewyork.com

ALL RIGHTS RESERVED. COPY OR REPRODUCTION OF THIS DRAWING OR DOCUMENT OR ANY PORTION THEREOF WITHOUT THE EXPRESS WRITTEN PERMISSION OF CHAZEN ENGINEERING, LAND SURVEYING & LANDSCAPE ARCHITECTURE CO., D.P.C. IS PROHIBITED. THIS DRAWING OR DOCUMENT IS NOT INTENDED OR REPRESENTED TO BE SUITABLE FOR ANY PURPOSE OTHER THAN THE SPECIFIC PROJECT, APPLICATION AND SITUATION FOR WHICH IT WAS INTENDED. ANY MODIFICATION OF THIS DRAWING OR DOCUMENT, OR ANY USE FOR ANY PROJECT, APPLICATION OR SITUATION OTHER THAN THAT FOR WHICH IT WAS INTENDED, WILL BE AT USER'S SOLE RISK AND WITHOUT LIABILITY TO CHAZEN ENGINEERING, LAND SURVEYING & LANDSCAPE ARCHITECTURE CO., D.P.C.
 IT IS A VIOLATION OF NEW YORK STATE EDUCATION LAW FOR ANY PERSON TO ALTER THIS DRAWING OR DOCUMENT IN ANY WAY, UNLESS HE OR SHE IS ACTING UNDER THE DIRECTION OF A LICENSED DESIGN PROFESSIONAL (PROFESSIONAL ENGINEER, LAND SURVEYOR, ARCHITECT OR LANDSCAPE ARCHITECT). IF THIS DRAWING OR DOCUMENT IS ALTERED, THE ALTERING DESIGN PROFESSIONAL SHALL AFFIX TO THE DRAWING OR DOCUMENT HIS OR HER SEAL, THE NOTATION "ALTERED BY FOLLOWED BY HIS OR HER SIGNATURE, THE DATE OF SUCH ALTERATION, AND A SPECIFIC DESCRIPTION OF THE ALTERATION."

THE Chazen COMPANIES
 Proud to be Employee Owned
 Civil Engineers
 Land Surveyors
 Planners
 Environmental & Safety Professionals
 Landscape Architects
 Transportation Planners & Engineers

CHAZEN ENGINEERING, LAND SURVEYING & LANDSCAPE ARCHITECTURE, CO., D.P.C.
 Office Locations:
 Hudson Valley Office: 21 Fox Street, Troy, New York 12601, Phone: (845) 454-3980
 Capital District Office: 547 River Street, Troy, New York 12180, Phone: (518) 273-0055
 North Country Office: 20 Elm Street, Suite 110, Glens Falls, New York 12601, Phone: (518) 812-0513
 Nashville Tennessee Office: 1705 Division Street, Nashville, Tennessee 37203, Phone: (615) 953-4909
 Westchester NY Office: 1 North Broadway, Suite 803, White Plains, New York 10601, Phone: (914) 997-8510
 Chattanooga Tennessee Office: 427 E. 5th St., Suite 201, Chattanooga, Tennessee 37403, Phone: (423) 241-6575

rev.	date	description
2	05/22/19	REVISED PER TOWN COMMENTS
1	04/24/19	REVISED PER TOWN COMMENTS
0	02/18/19	INITIAL SUBMISSION TO PLANNING BOARD

GAS LAND CORTLANDT- 2051 & 2053 EAST MAIN STREET (U.S. ROUTE 6)
LANDSCAPE PLAN
 TOWN OF CORTLANDT, WESTCHESTER COUNTY, NEW YORK

designed SPL checked CPL
 date 02/20/19 scale 1"=20'
 project no. 81903.00
 sheet no. **C180**