

**Legend**

- Photo Location
- Profile Lines
- Proposed Solar Arrays
- Proposed Fence

C&S Engineers, Inc.  
499 Col. Eileen Collins Blvd.  
Syracuse, New York 13212  
Phone: 315-455-2000  
Fax: 315-455-9667  
www.cscs.com

0 160 Feet  
1 inch = 160 feet

Lexington Avenue  
Solar Project  
Cortlandt, New York

PROJECT NO:	W09
DATE:	February 2021
SCALE:	AS SHOWN
DRAWN BY:	
DESIGNED BY:	
CHECKED BY:	

## Profile Map

NAD 1983 CORS96 StatePlane New York East FIPS 3101 Ft US  
Projection: Transverse Mercator  
Datum: NAD 1983 CORS96  
False Easting: 492,125.0000  
False Northing: 0.0000  
Central Meridian: -74.5000  
Scale Factor: 0.9999  
Latitude Of Origin: 38.8333  
Units: Foot US

Source: Esri, Maxar, GeoEye, Earthstar Geographics, CNES/Airbus DS, USDA, USGS, AeroGRID, IGN, and the GIS User Community

Document Path: F:\Project\W09 - Dimension Energy, LLC\W0904.001 - Kulick Site\Planning-Study\GIS\Projects\Profile Map2.mxd

1

2

3

4

From Pos: 669352.40, 897256.01

Minimum Clearance: 4.2 ft at 669034.87, 897242.08

To Pos: 668872.58, 897234.96

**Proposed Solar Arrays**

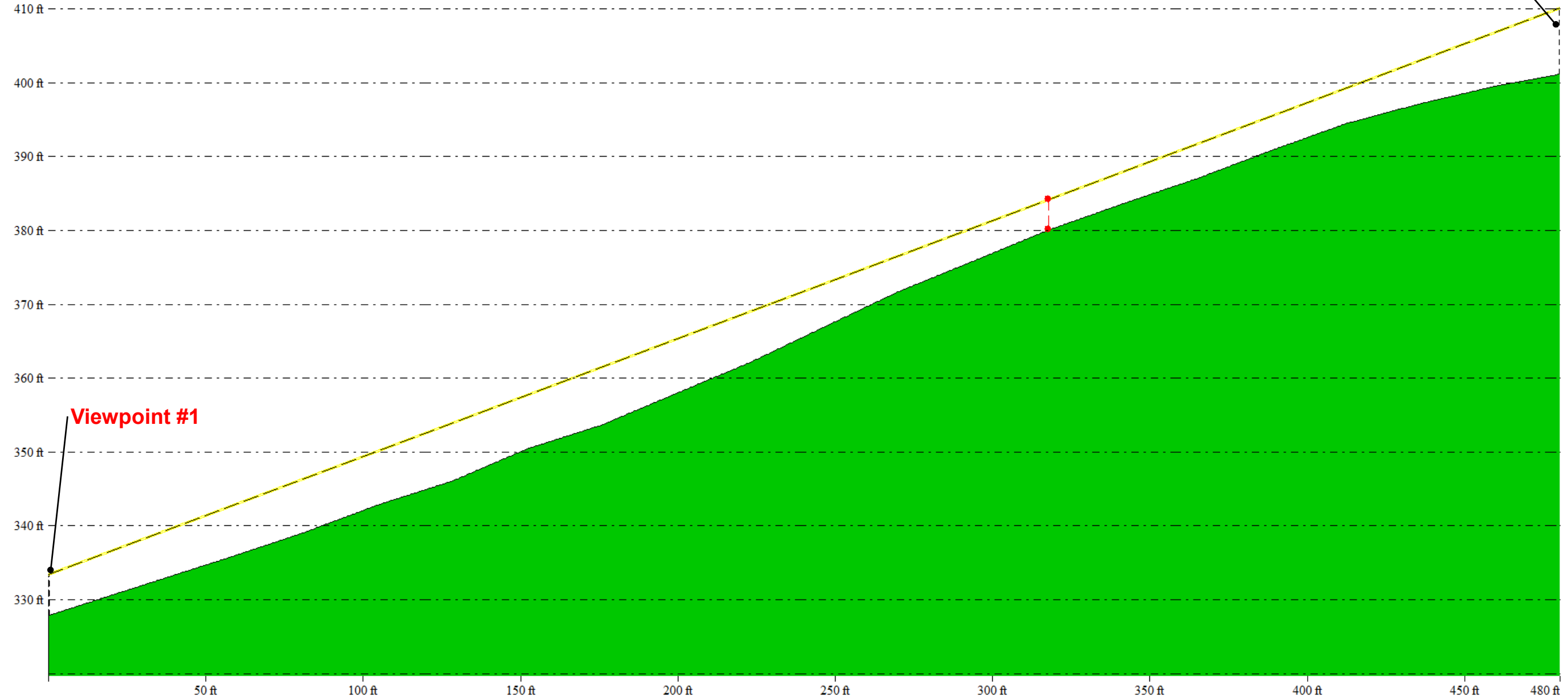

C&S Engineers, Inc.  
499 Col. Eileen Collins Blvd.  
Syracuse, New York 13212  
Phone: 315-455-2000  
Fax: 315-455-9667  
www.cscs.com



0 160 Feet  
1 inch = 160 feet

Lexington Avenue  
Solar Project  
Cortlandt, New York

PROJECT NO:	W09
DATE:	February 2021
SCALE:	AS SHOWN
DRAWN BY:	
DESIGNED BY:	
CHECKED BY:	

**Profile 1**

1

2

3

4

1

2

3

4

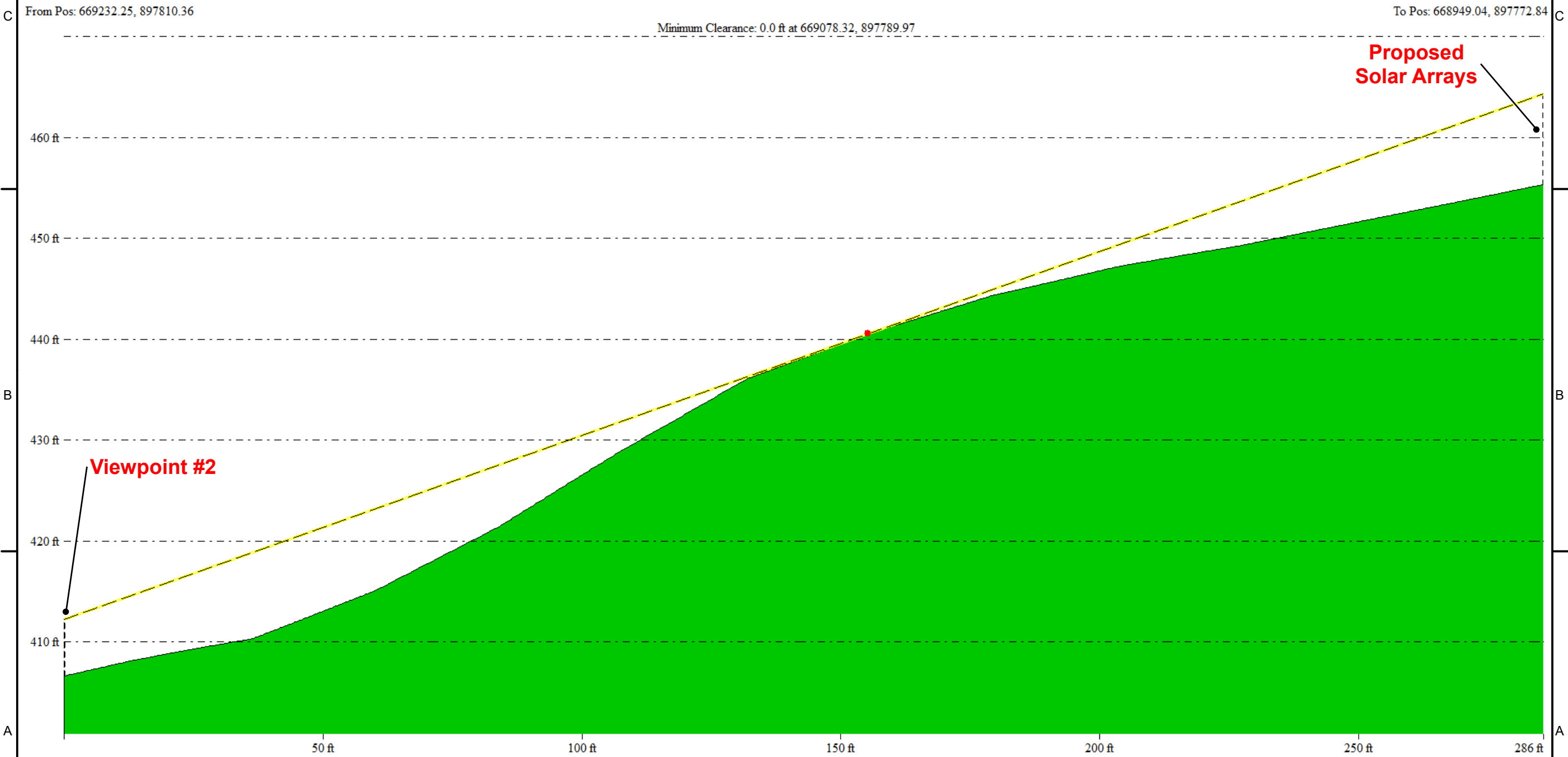

C&S Engineers, Inc.  
 499 Col. Eileen Collins Blvd.  
 Syracuse, New York 13212  
 Phone: 315-455-2000  
 Fax: 315-455-9667  
 www.cscs.com

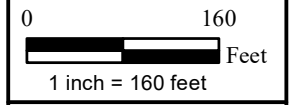

Lexington Avenue  
 Solar Project  
 Cortlandt, New York

PROJECT NO:	W09
DATE:	February 2021
SCALE:	AS SHOWN
DRAWN BY:	
DESIGNED BY:	
CHECKED BY:	

Modified: 2/22/21 @ 11:03 AM

# Profile 2

1

2

3

4

1

2

3

4

From Pos: 668917.14, 897961.41

To Pos: 668910.81, 897835.64

Minimum Clearance: 5.6 ft at 668917.14, 897961.41

C

C

495 ft

490 ft

485 ft

480 ft

475 ft

470 ft

465 ft

460 ft

455 ft

B

B

**Viewpoint #3**

**Proposed Solar Arrays**



C&S Engineers, Inc.  
499 Col. Eileen Collins Blvd.  
Syracuse, New York 13212  
Phone: 315-455-2000  
Fax: 315-455-9667  
www.cscs.com



0 160 Feet  
1 inch = 160 feet

Lexington Avenue  
Solar Project  
Cortlandt, New York

PROJECT NO: W09  
DATE: February 2021  
SCALE: AS SHOWN  
DRAWN BY:  
DESIGNED BY:  
CHECKED BY:  
Modified: 2/22/2021 @ 1:53:28 PM

**Profile 3**

1

2

3

4

A

A

1

2

3

4

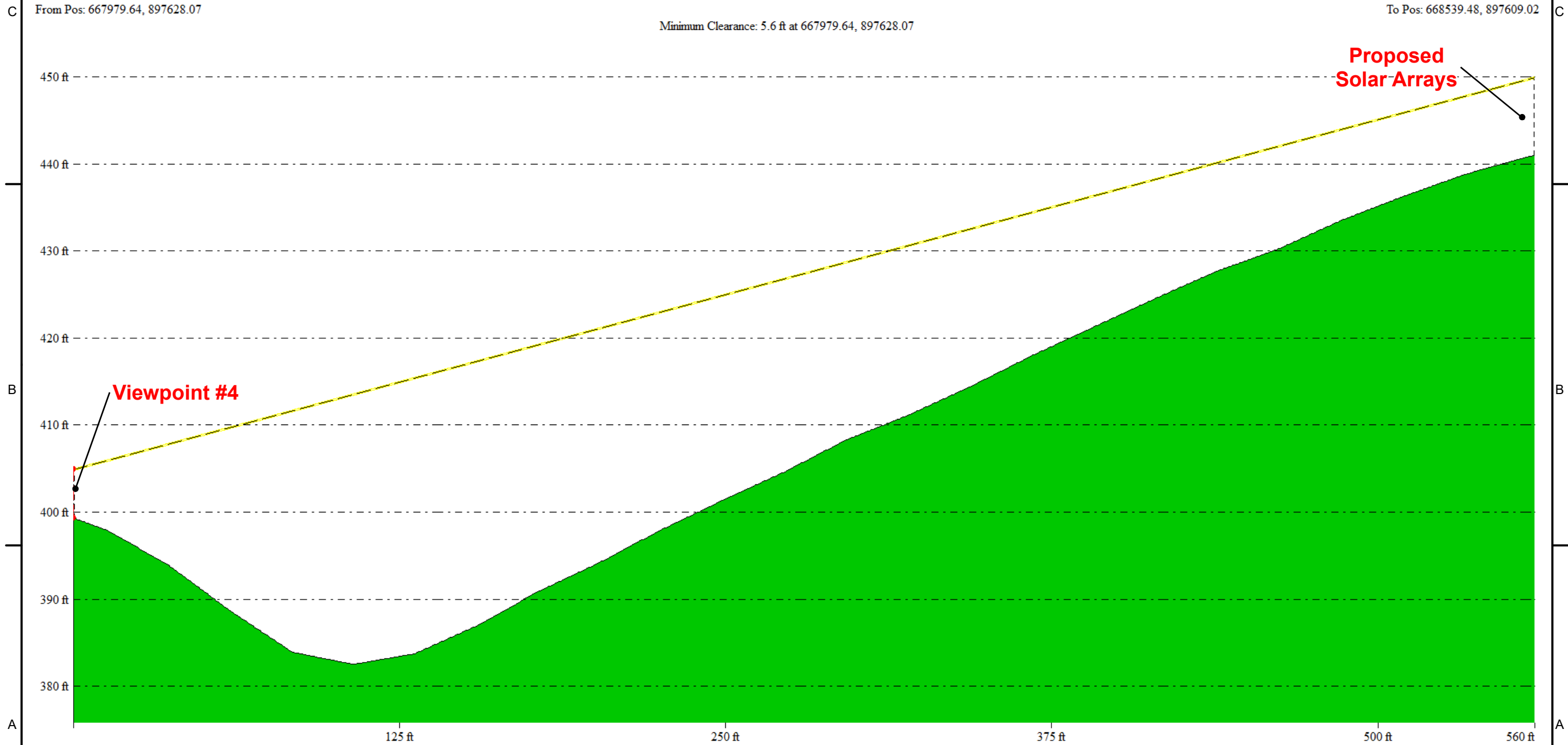

C&S Engineers, Inc.  
 499 Col. Eileen Collins Blvd.  
 Syracuse, New York 13212  
 Phone: 315-455-2000  
 Fax: 315-455-9667  
 www.cscs.com

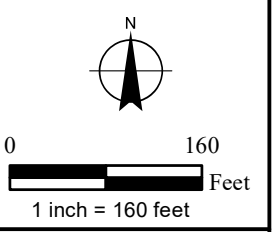

Lexington Avenue  
 Solar Project  
 Cortlandt, New York

PROJECT NO:	W09
DATE:	February 2021
SCALE:	AS SHOWN
DRAWN BY:	
DESIGNED BY:	
CHECKED BY:	

**Profile 4**

1

2

3

4

C

From Pos: 668068.18, 897096.82

Minimum Clearance: 5.6 ft at 668068.18, 897096.82

**Proposed Solar Arrays**

To Pos: 668468.49, 897153.05

C

400 ft

390 ft

380 ft

B

370 ft

360 ft

**Viewpoint #5**

350 ft

A

50 ft

100 ft

150 ft

200 ft

250 ft

300 ft

350 ft

404 ft

A

Document Path: F:\Project\W09 - Dimension Energy LLC\W09044001 - Kulick Site\Planning-Study\GIS\Projects\Profile 5.mxd

1

2

3

4



C&S Engineers, Inc.  
499 Col. Eileen Collins Blvd.  
Syracuse, New York 13212  
Phone: 315-455-2000  
Fax: 315-455-9667  
www.cscs.com

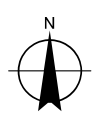

0 160 Feet  
1 inch = 160 feet

Lexington Avenue  
Solar Project  
Cortlandt, New York

PROJECT NO: W09  
DATE: February 2021  
SCALE: AS SHOWN  
DRAWN BY:  
DESIGNED BY:  
CHECKED BY:  
Modified: 2/22/2021 @ 2:00:38 PM

**Profile 5**

1

2

3

4



C&S Engineers, Inc.  
499 Col. Eileen Collins Blvd.  
Syracuse, New York 13212  
Phone: 315-455-2000  
Fax: 315-455-9667  
www.cscs.com

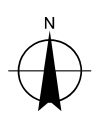

0 160 Feet  
1 inch = 160 feet

Lexington Avenue  
Solar Project  
Cortlandt, New York

PROJECT NO: W09  
DATE: February 2021  
SCALE: AS SHOWN  
DRAWN BY:  
DESIGNED BY:  
CHECKED BY:  
Modified: 02/20/21 @ 2:02:20 PM

# Profile 6

From Pos: 667648.91, 896893.70

Minimum Clearance: 5.6 ft at 667648.91, 896893.70

Proposed  
Solar Arrays

To Pos: 668493.06, 897098.44

Viewpoint #6

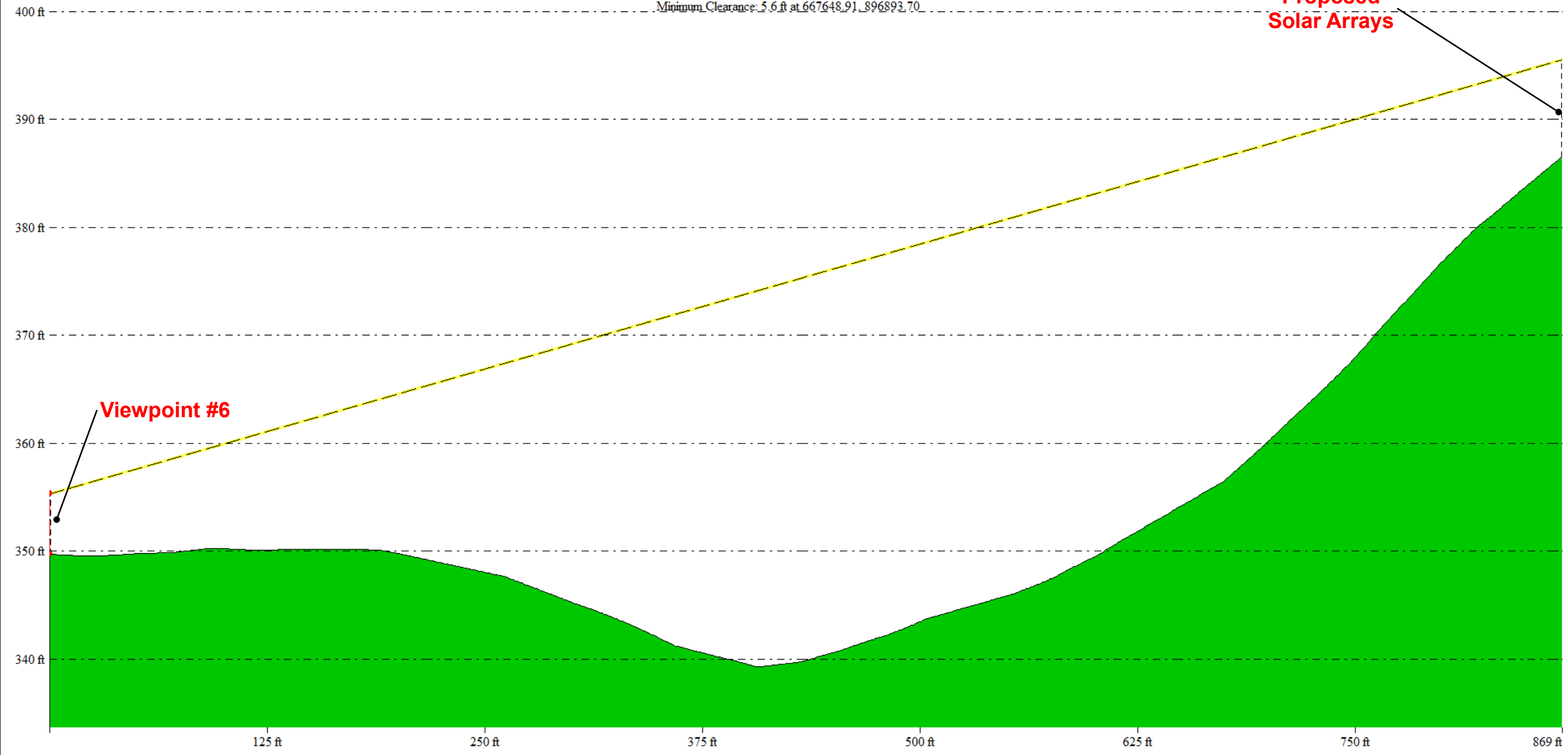

1

2

3

4

1

2

3

4



C&S Engineers, Inc.  
499 Col. Eileen Collins Blvd.  
Syracuse, New York 13212  
Phone: 315-455-2000  
Fax: 315-455-9667  
www.cscs.com



0 160 Feet  
1 inch = 160 feet

Lexington Avenue  
Solar Project  
Cortlandt, New York

PROJECT NO: W09  
DATE: February 2021  
SCALE: AS SHOWN  
DRAWN BY:  
DESIGNED BY:  
CHECKED BY:  
Modified: 2/22/2021 @ 2:03:07 PM

# Profile 7

From Pos: 668771.31, 896542.14

Minimum Clearance: -8.3 ft at 668767.72, 896829.13

**Proposed Solar Arrays**  
To Pos: 668763.37, 897177.62

**Viewpoint #7**

