

BUTTONWOOD ROAD

PLANT LIST

KEY QTY	BOTANICAL NAME	COMMON NAME	SIZE	ROOT	COMMENT
TREES					
PO 7	QUERCUS PALUSTRIS	PIN OAK	10 GAL	CAN	HOLDS LEAVES INTO WINTER
RM 5	ACER RUBRUM	RED MAPLE	10 GAL	CAN	BRILLIANT RED FALL COLOR
GA 2	FRAXINUS PENNSYLVANICA	GREEN ASH	10 GAL	CAN	BRILLIANT FALL COLOR
BT 4	NYSSA SYLVATICA	BLACK TUPELO	10 GAL	CAN	BRILLIANT RED FALL COLOR
DG 2	CORNUS FLORIDA	DOGWOOD	7 GAL	CAN	WHITE SPRING FLOWERS/FALL FRUIT
HK 2	CELTIS OCCIDENTALIS	HACKBERRY	10 GAL	CAN	FALL COLOR & BERRIES
SC 1	MALUS SARGENII	SARGENT CRAB APPLE	7 GAL	CAN	SPRING FLOWERS, FALL FRUIT
SHRUBS					
BB 23	MYRTICA PENNSYLVANICA	BAYBERRY	2 GAL	CAN	SEMI-EVERGREEN
IB 6	ILEX GLABRA	INKBERRY	2 GAL	CAN	EVERGREEN
STJ 14	HYPERICUM HIDCOTE	ST. JOHN'S WORT	2 GAL	CAN	YELLOW SUMMER FLOWERS
CB 10	VIBURNUM CORYMBOSUM	CRANBERRY BUSH	2 GAL	CAN	SPRING FLOWERS/FALL FRUIT
MB 8	ILEX VERTICILLATA	WINTERBERRY	2 GAL	CAN	RED WINTER FRUIT
SS 12	CLETHRA ALNIFOLIA	SUMMERSHEET	2 GAL	CAN	WHITE SUMMER FLOWERS
SD 4	CORNUS ALNOMIFA	SILKY DOGWOOD	2 GAL	CAN	SPRING FLOWERS, RED FALL FOLIAGE
VS 10	ITEA VIRGINICA	VIRGINIA SHEETSPIRE	2 GAL	CAN	SPRING FLOWERS, RED FALL FOLIAGE
RT 10	CORNUS STOLONIFERA	REDTHING DOGWOOD	2 GAL	CAN	RED WINTER STEMS
MS 11	SPIREA LATIFOLIA	MEADOW SHEET	2 GAL	CAN	SPRING FLOWERS
PERENNIALS					
CF 11	ECHINACEA PURPUREA	PURPLE CONEFLOWER	1 GAL	CAN	PURPLE SUMMER FLOWERS
RD 7	RUDEBECKIA GOLDSTRUM	BLACK-EYED SUSAN	1 GAL	CAN	YELLOW SUMMER FLOWERS
OX 15	Oxyanthemum leucanthemum	OXEYE DAISY	1 GAL	CAN	WHITE SUMMER FLOWERS
BE 11	MONARDA FISTULOSA	BEEBALM	1 GAL	CAN	LAVENDER SUMMER FLOWERS
JPT 6	EUPATORIUM MACULATUM	JOE PYE WEED	1 GAL	CAN	SUMMER FLOWERS



AERIAL
NTS

(A) INVASIVE PLANT REMOVAL SEQUENCE

1. IDENTIFY THE SUBJECT AREA WHERE INVASIVE PLANTS ARE TO BE REMOVED. FLAGGING OF THE SUBJECT AREA WHERE REMOVALS ARE TO BE PERFORMED CAN BE DONE BY ENVIRONMENTAL CONSULTANT, LANDSCAPE ARCHITECT OR SURVEYOR.
2. IDENTIFY THE INVASIVE PLANTS TO BE REMOVED. IN THIS CASE THE PRINCIPAL INVASIVE PLANTS TO BE REMOVED ARE WILD RASPBERRY/BLACKBERRY, JAPANESE BARBERRY AND MULTIFLORA ROSE.
3. IDENTIFY THE NATIVE PLANTS TO BE PRESERVED AND FLAG THEM WITH COLORED TAPE TO PROTECT THEM FROM REMOVAL.
4. CUT DOWN THE INVASIVE PLANT MATERIALS TO THE GROUND LEVEL. REMOVE ALL THE BRUSH AND VINES FROM THE SITES IN A DUMPSTER OR DUMP TRUCK.
5. INSTALL SILT FENCE AT THE TREE LINE/ WETLAND, PER THE PLAN.
6. USING AN EXCAVATOR GRAB OUT THE INVASIVE ROOT SYSTEM IN THE MITIGATION AREA. REMOVE ALL ROOTS, VINES, SHRUBS, ETC. TO THE DUMPSTER OR DUMP TRUCKS. RAKE THE AREA CLEAN WITH THE BACKHOE BUCKET TO SMOOTH CLEAN LINES FOLLOWING ROOT SYSTEM REMOVAL.
7. HAND RAKE/FINE RAKE ALL THE MITIGATION AREAS TO SMOOTH AND CLEAN LINES. DISCARD LOOSE STONES OVER 4" DIAMETER. WHILE THE SOIL IS STILL SOFT AND FRIABLE, INSTALL THE MITIGATION PLANTINGS AND SEED MIXES. COVER THE SEED MIXES WITH NEED FREE HAY OVER SALT HAY.
8. PRESERVE THE NATIVE TREES AND SHRUBS IN THE MITIGATION AREA, AS DIRECTED BY THE ARCHITECT.

(B) NATIVE PLANT INSTALLATION

1. INSTALL THE NATIVE PLANTS PER THE APPROVED PLANTING PLAN.
2. ONCE THE LIVE PLANTS ARE INSTALLED, INSTALL THE SEED MIX PER THE INSTRUCTIONS BELOW.

(C) SEEDING METHOD

1. START WITH CLEARING DEBRIS OF ROCKS OR SOIL CLUMPS GREATER THAN TWO INCHES IN DIAMETER.
2. MIX ALL SEED WITH SLIGHTLY DAMPENED SAND/ST OR VERMICULITE (APPROXIMATELY TWO BUSHEL BASKETS OF SAND/ST PER 1000 SQUARE FEET).
3. DIVIDE THE SEED MIXTURE INTO TWO EQUAL GROUPS.
4. HAND BROADCAST ONE HALF OF THE SEED EVENLY OVER THE PLANTING AREA.
5. HAND BROADCAST THE SECOND HALF OF THE SEED OVER THE SITE, WALKING PERPENDICULAR TO THE DIRECTION WALKED WHEN SEEDING THE FIRST HALF. THIS ENSURES EVEN SEED DISTRIBUTION.

(D) POST PLANTING MAINTENANCE

1. SEE FIVE YEAR MONITORING AND MAINTENANCE PLAN DOCUMENT.

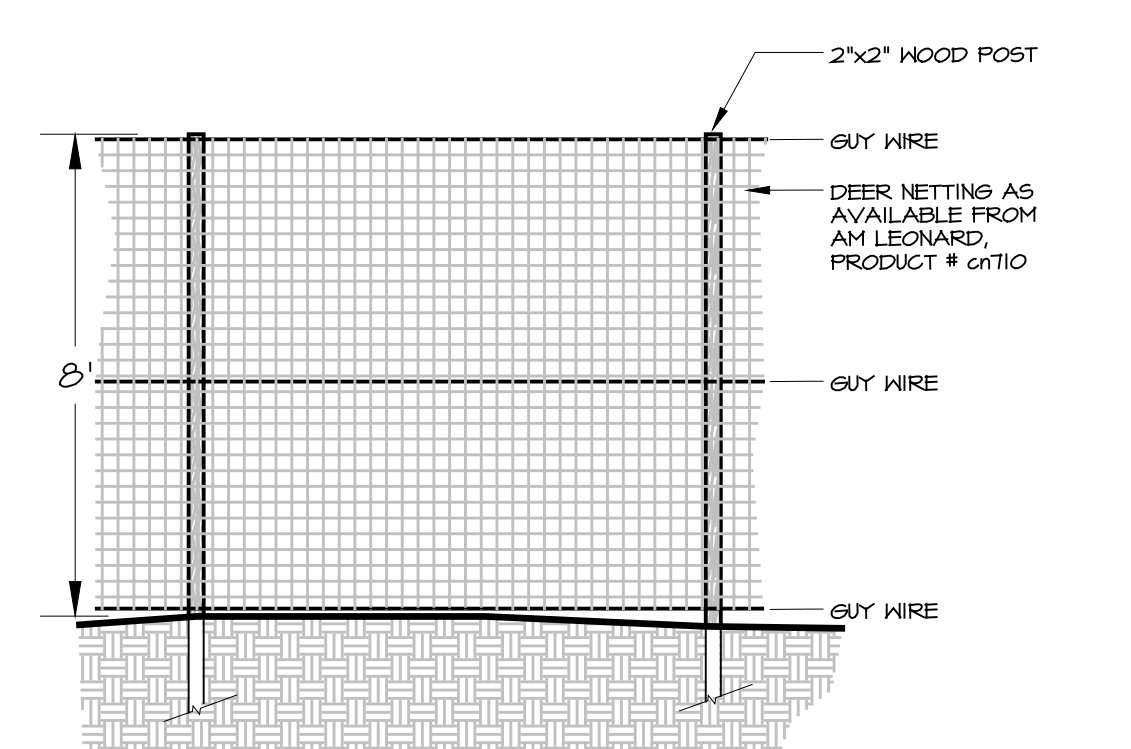
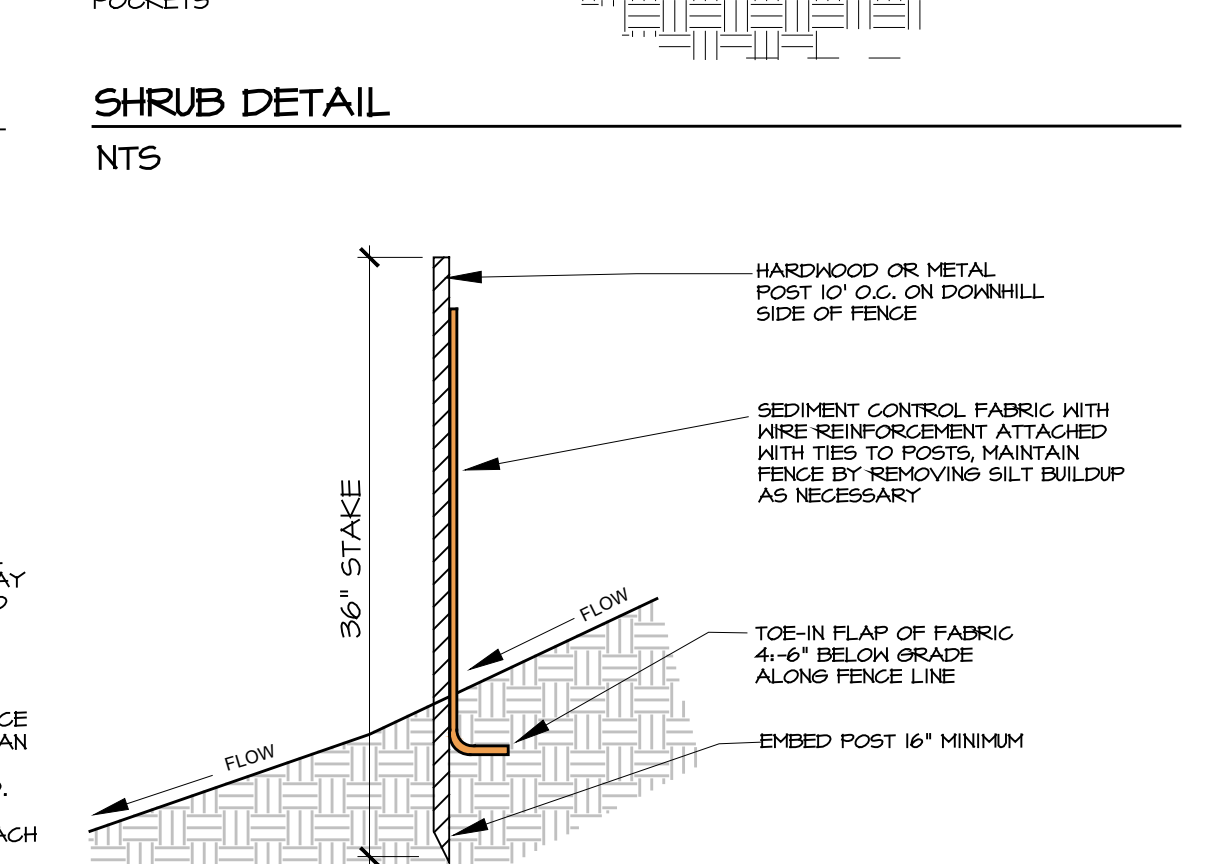
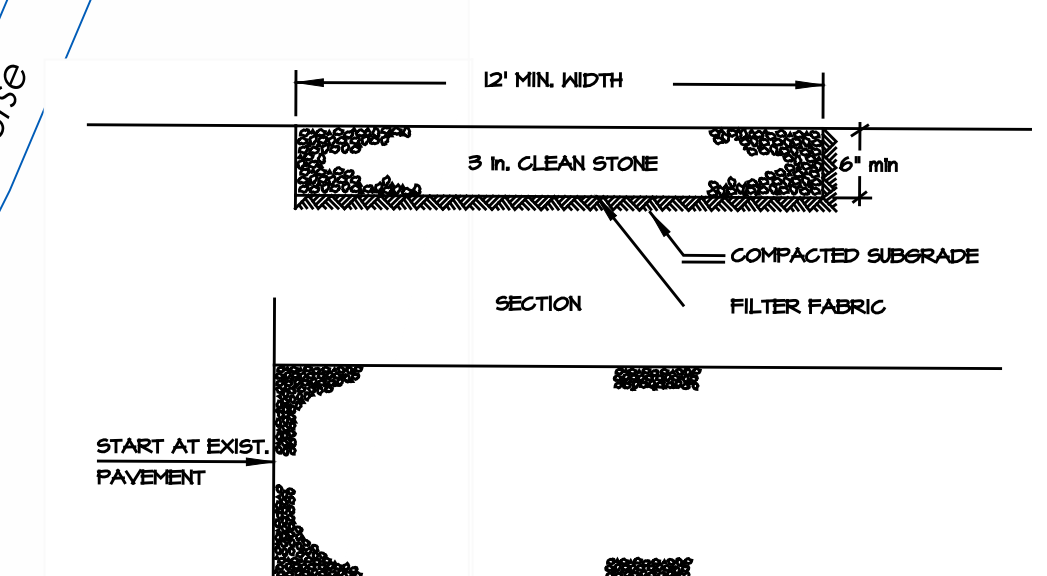
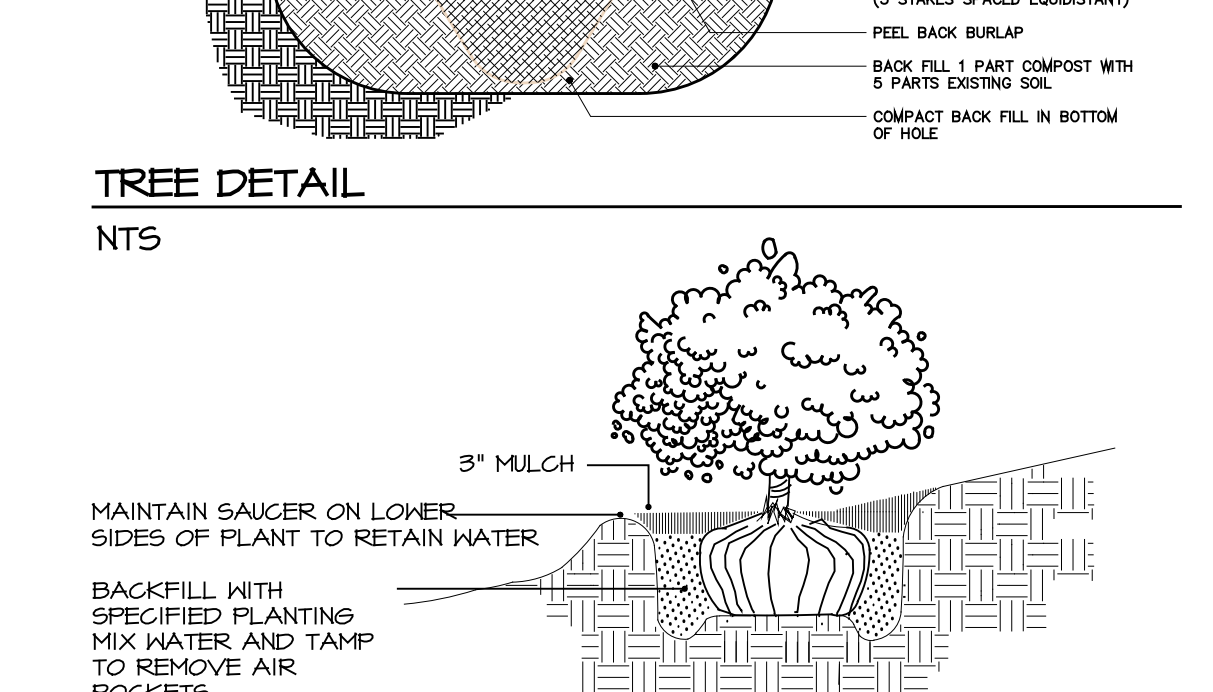
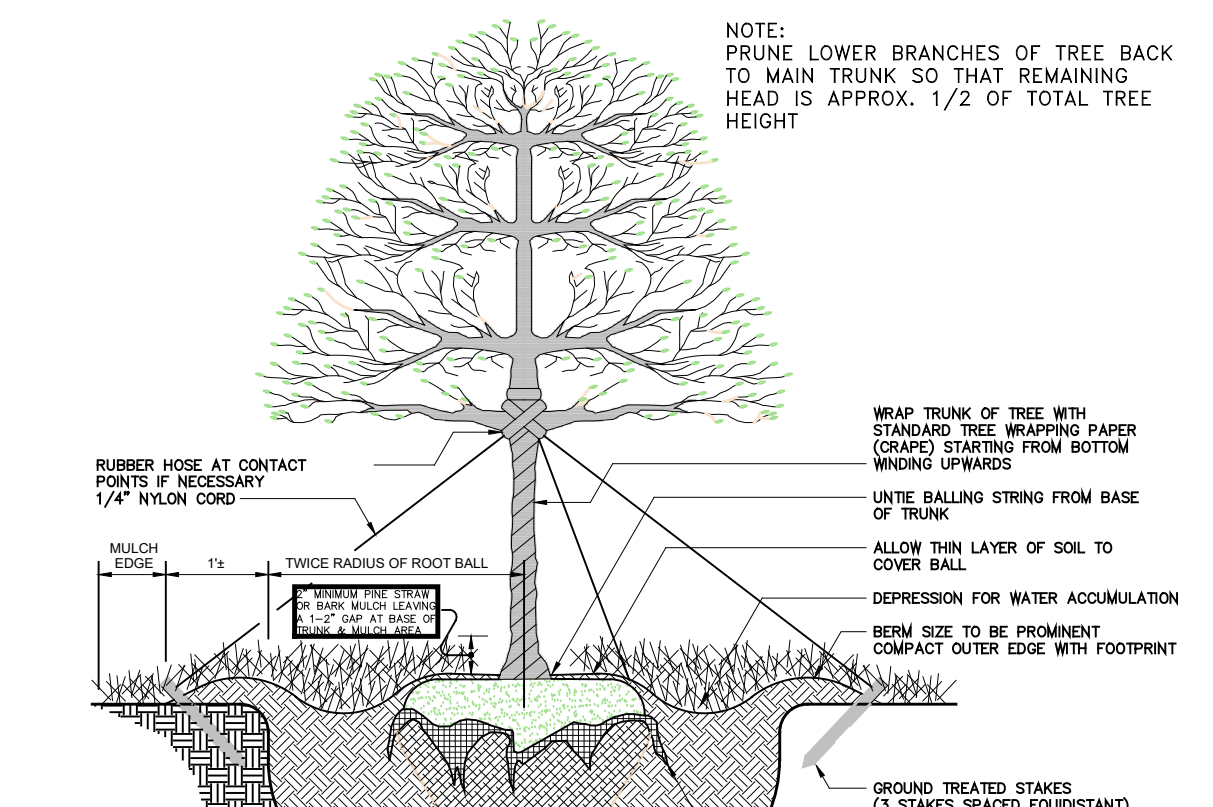

- ### INSTALLATION NOTES
1. STONE SIZE - USE 6-8" SURGE STONE OR RECLAIMED OR RECYCLED CONCRETE EQUIVALENT.
 2. LENGTH - AS REQUIRED 50' MIN. SEE PLAN.
 3. THICKNESS - NOT LESS THAN SIX (6) INCHES.
 4. WIDTH - 12 FOOT MINIMUM, BUT NOT LESS THAN THE FULL WIDTH AT POINTS WHERE INGRESS OR EGRESS OCCUR.
 5. FILTER CLOTH - WILL BE PLACED OVER THE ENTIRE AREA PRIOR TO PLACING OF STONE. FILTER CLOTH WILL NOT BE REQUIRED ON A SINGLE FAMILY RESIDENCE LOT.
 6. SURFACE WATER - ALL SURFACE WATER FLOWING OR DIVERTED TOWARD CONSTRUCTION ENTRANCES SHALL BE PIPED ACROSS THE ENTRANCE. IF PIPING IS IMPRACTICAL, A MONITABLE BERRY WITH SIX SLORES WILL BE PROVIDED.
 7. MAINTENANCE - THE ENTRANCE SHALL BE MAINTAINED IN A CONDITION WHICH WILL PREVENT TRACKING OR FLOWING OF SEDIMENT ONTO PUBLIC RIGHT OF WAY. THIS MAY REQUIRE PERIODIC TOP DRESSING WITH ADDITIONAL STONE AS CONDITIONS DEMAND AND REPAIR AND/OR CLEANOUT OF ANY MEASURES USED TO TRAP SEDIMENT. ALL SEDIMENT SPILLED, DROPPED, WASHED OR TRACKED ONTO PUBLIC RIGHT OF WAY MUST BE REMOVED IMMEDIATELY.
 8. WASHING - TIRES SHALL BE CLEANED TO REMOVE SEDIMENT PRIOR TO ENTRANCE ONTO PUBLIC RIGHT OF WAY. WHEN WASHING IS PERFORMED IT SHALL BE DONE ON AN AREA STABILIZED WITH STONE AND WHICH DRAINS INTO AN APPROVED SEDIMENT TRAPPING DEVICE. TIRE WASHING REQUIRED BEFORE VEHICLE ENTERS PUBLIC ROAD.
 9. PERIODIC INSPECTION AND NEEDED MAINTENANCE SHALL BE PROVIDED AFTER EACH RAIN.

MITIGATION PLANTING PLAN

Prepared For:
WESTCHESTER AUTO EXCHANGE
2311 CROMPOND RD
CORTLANDT NY
Tax Map 34.07-2-4

Prepared by:
Landscape Architect/Environmental Planner:
J.L.D. BARRETT & ASSOCIATES, LLC
104 SPORT HILL ROAD
EASTON, CONNECTICUT 06612
Tel. 203.372.5805 Fax 203.372.0449

Architect:
ARCHITECTURAL VISIONS, PLLC
2 MUSCOG RD. NORTH
MAHOPAC, NY 10541
Tel. 845.628.6615

Wetlands Scientist:
PAUL J. JAENIG WETLANDS AND
SOIL CONSULTING
P.O. BOX 1071 RIDGEFIELD, CT 06871
Tel. 203.438.4943
Surveyor:
T. C. MERRITS LAND SURVEYORS, P.C.
394 BEDFORD ROAD
PLEASANTVILLE, NEW YORK 10570
Tel. 914.164.8009 Fax 203.622.8849
Scale: 1"=10'
Date: January 28, 2020

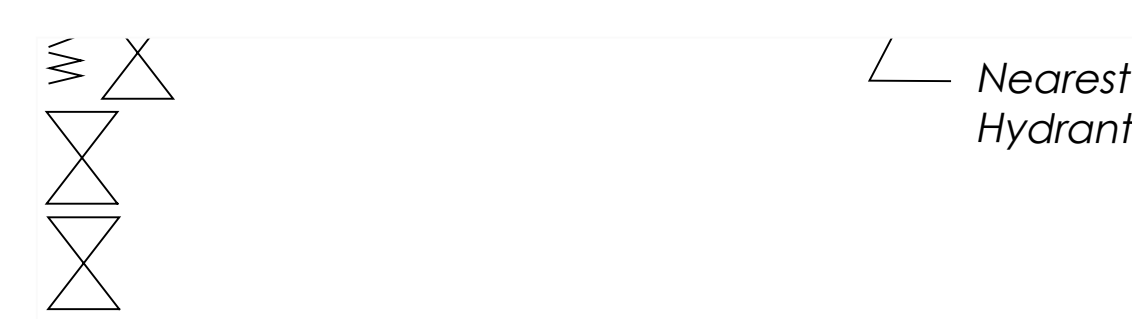

CROMPOND ROAD

MITIGATION PLANTING PLAN

SCALE: 1"=10'

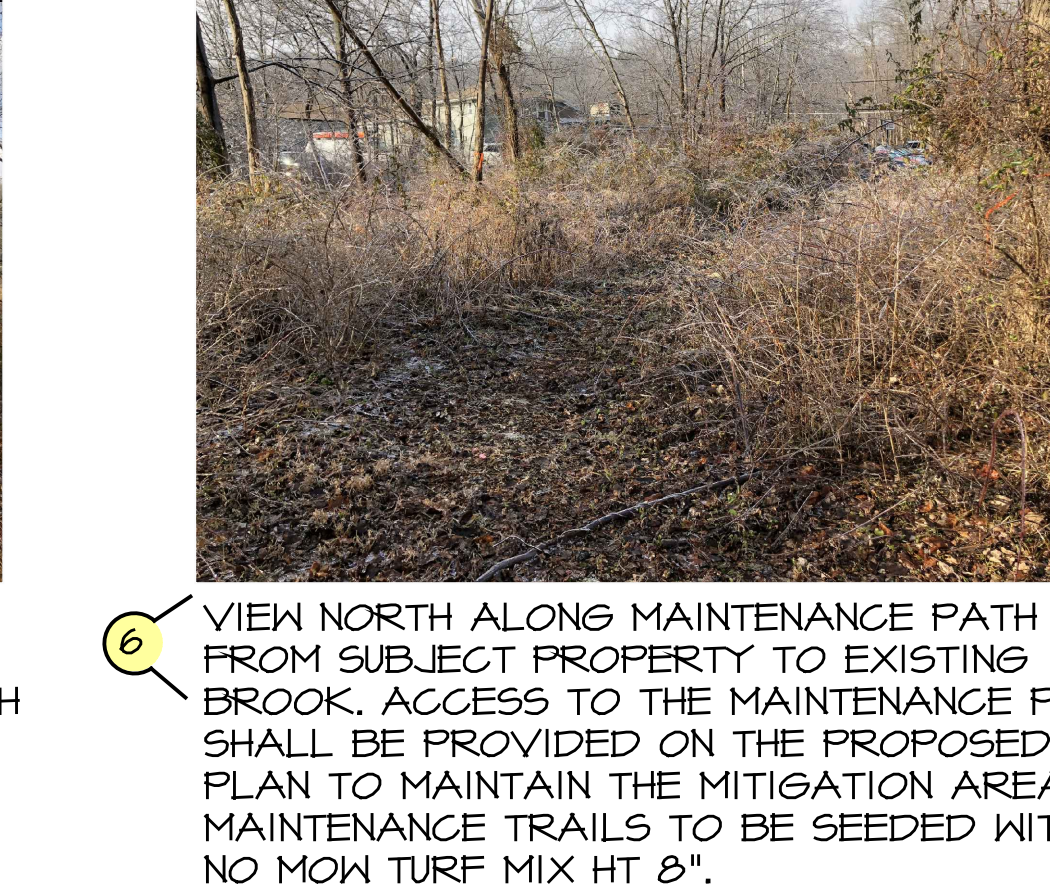
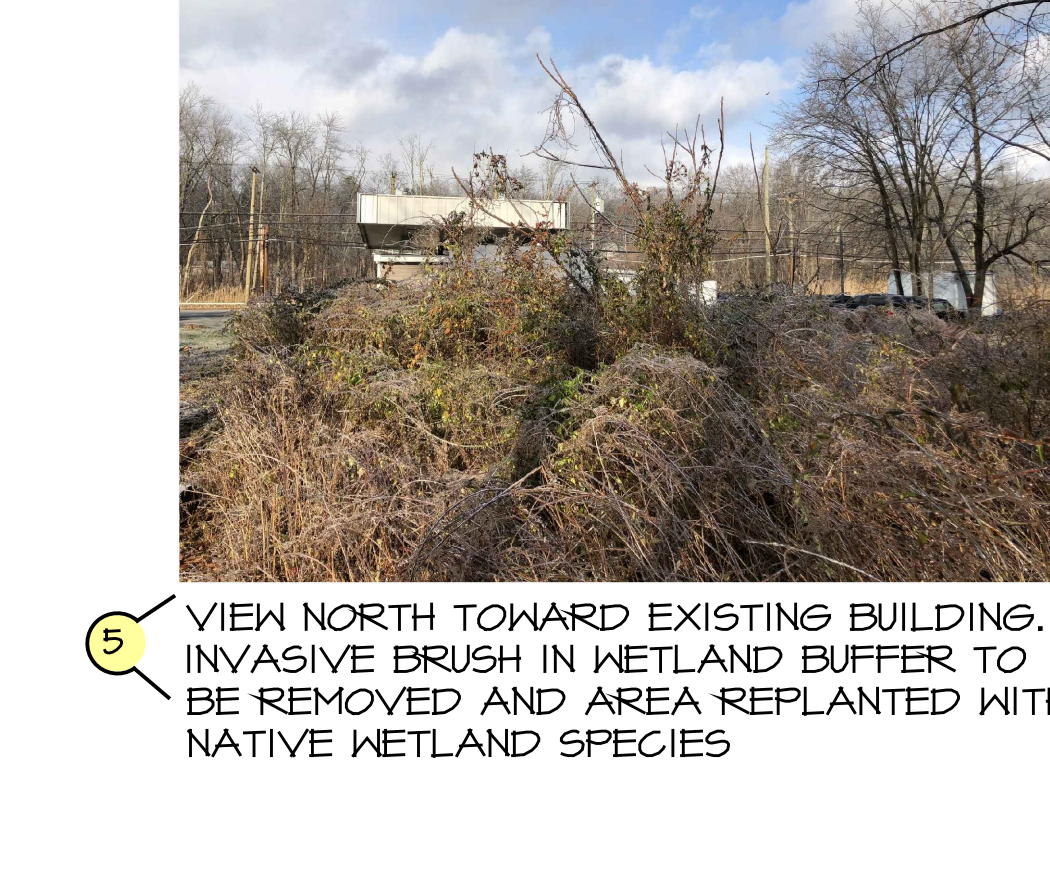
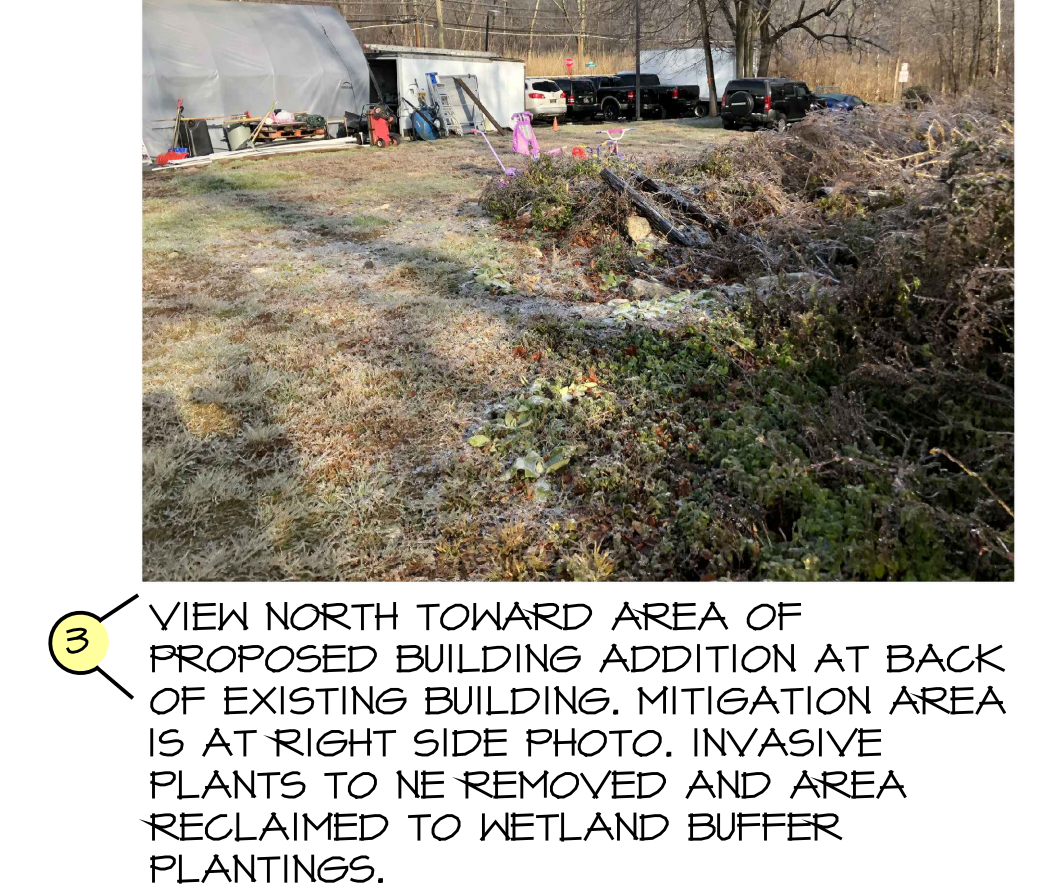

1. VIEW SOUTH ON WEST SIDE OF EXISTING BUILDING LOOKING TOWARD PROPOSED WETLAND MITIGATION AREA. EX FIELD AND INVASIVE BRUSH TO BE RECLAIMED TO NATIVE WETLAND BUFFER ENHANCEMENT PLANTINGS

2. VIEW EAST OVER REAR FIELD AREA AND INVASIVE BRUSH WETLAND EDGE. LAWN AREA IN CENTER PHOTO IS SEPTIC AREA AND WILL REMAIN MOWED GRASS. AREA AT MID PHOTO AND TO RIGHT (SOUTH) IS THE MITIGATION AREA

3. VIEW NORTH TOWARD AREA OF PROPOSED BUILDING ADDITION AT BACK OF EXISTING BUILDING. MITIGATION AREA IS AT RIGHT SIDE PHOTO. INVASIVE PLANTS TO BE REMOVED AND AREA RECLAIMED TO WETLAND BUFFER PLANTINGS.

4. VIEW WEST TOWARD AREA OF PROPOSED ADDITION ADJACENT TO EXISTING STRUCTURE. AREA TO LEFT IS THE MITIGATION AREA.

5. VIEW NORTH TOWARD EXISTING BUILDING, INVASIVE BRUSH IN WETLAND BUFFER TO BE REMOVED AND AREA REPLANTED WITH NATIVE WETLAND SPECIES

6. VIEW NORTH ALONG MAINTENANCE PATH FROM SUBJECT PROPERTY TO EXISTING BROOK. ACCESS TO THE MAINTENANCE PATH SHALL BE PROVIDED ON THE PROPOSED PLAN TO MAINTAIN THE MITIGATION AREAS. MAINTENANCE TRAILS TO BE SEEDED WITH NO MOW TURF MIX HT 8".

PROPOSED EASEMENT TO BE GRANTED TO THE TOWN OF CORTLANDT FOR THE EAST OF HUDSON PROJECT. ACTUAL COURSES AND DISTANCES TO BE DETERMINED BY THE TOWN.

EXCAVATOR PROPOSED TO GRUB OUT ALL ROOT SYSTEMS OF INVASIVE PLANT MATERIAL
Area = 79,963.63 sq. ft. = 1.835 acres

"DEC Wetland A-35"

Wetlands Delineation by Paul J. Jaehrig
Wetlands and Soils Consulting
June 22, 2018

TEMPORARY DEER FENCE
SILT FENCE

NOTE: PRUNE LOWER BRANCHES OF TREE BACK TO MAIN TRUNK SO THAT REMAINING HEAD IS APPROX. 1/2 OF TOTAL TREE HEIGHT.

MAINTAIN SAUCER ON LOWER SIDES OF PLANT TO RETAIN WATER

BACKFILL WITH SPECIFIED PLANTING MIX WATER AND TAMP TO REMOVE AIR POCKETS

SCALE: NTS

SCALE: NTS

SCALE: NTS